

DEER RUN

Lying in Sections 21, 22, 23 & 26, Township 43 South, Range 40 East, Palm Beach County, Florida
September, 1977

DEDICATION:

KNOW ALL MEN BY THESE PRESENTS THAT SAFARI RANCHETTE ESTATES, INC., A FLORIDA CORPORATION; AND CHARLES A. NUGENT, JR. AND BARBARA A. NUGENT, HIS WIFE, JOHN B. McCracken and CAROL A. McCracken, HIS WIFE, KEVIN A. REGAN, A SINGLE MAN, DOUGLAS G. HOWELL and ANN A. HOWELL, HIS WIFE, CLYDE D. COCHRAN and ANN S. COCHRAN, HIS WIFE, RAY A. MAIURUM, D.D.S. and JUDITH E. MAIURUM, HIS WIFE, ALAN J. CIKLIN, A SINGLE MAN, H. NORMAN BOTT and MARY E. BOTT, HIS WIFE, DAVID ROTH and NANCY ROTH, HIS WIFE, LAKE LYTAL, JR. and SUSAN LYTAL, HIS WIFE, JOSEPH J. REITER and JANICE REITER, HIS WIFE, DR. HARRY E. LANGE, LAWRENCE KLEIN and LYNN KLEIN, HIS WIFE, CHARLES R. REIF and IVA M. REIF, HIS WIFE, PHILIP G. BUTLER, JR., A SINGLE MAN, DONALD J. SMITH and JANE SMITH, HIS WIFE, DONALD A. HUGHES, JR. and MARY LOU HUGHES, HIS WIFE, RICHARD G. LUBIN and LOIS J. FRANKEL, HIS WIFE, PETER A. MANZ and SARAH H. MANZ, HIS WIFE, JERRY G. GUFFEY, D.D.S., P.A. PROFIT SHARING TRUST, IAN MURPHY and ROSE MARIE MURPHY, HIS WIFE, STEWART W. WOOFENDEN, TRUSTEE OF THE STEWART W. WOOFENDEN, D.O., P.A. PENSION TRUST, GENE A. TONN, SAMUEL YELIN, CARLOS RODRIGUEZ, MAXIMO GOMEZ, MILTON LAVERNIA, ANTONIO LOPEZ, JOSEPH W. WALIGA and LILLIAN C. WALIGA, HIS WIFE, ALBERT ASSADOURIAN, BY THOMAS S. WALDRON, THEIR ATTORNEY IN FACT, BY VIRTUE OF THOSE CERTAIN POWERS OF ATTORNEY RECORDED IN O.R. BOOK 2576 PAGES 41 & 42 THROUGH 50, INCLUSIVE, OWNERS OF THE LAND SHOWN HEREON, LYING IN SECTIONS 21, 22, 23, AND 26, TOWNSHIP 43 SOUTH, RANGE 40 EAST, PALM BEACH COUNTY, FLORIDA, SHOWN HEREON AS DEER RUN, A RURAL SUBDIVISION, AND BEING MORE PARTICULARLY DESCRIBED AS FOLLOWS:

BEGINNING AT THE NORTHEAST CORNER OF SAID SECTION 22; THENCE, BEAR SOUTH 00°11'02" WEST, ALONG THE EAST LINE OF SAID SECTION 22, A DISTANCE OF 5023.42 FEET; THENCE, SOUTH 89°04'05" EAST, ALONG THE NORTH LINE OF THE SOUTH 460.00 FEET OF SAID SECTION 23, A DISTANCE OF 290.01 FEET TO THE EAST LINE OF THE WEST 290.00 FEET OF SAID SECTION 23; THENCE, SOUTH 00°11'02" WEST, ALONG SAID LINE, A DISTANCE OF 360.03 FEET TO THE NORTH LINE OF THE SOUTH 100.00 FEET OF SAID SECTION 23; THENCE, SOUTH 89°04'05" EAST, ALONG SAID LINE, A DISTANCE OF 2345.16 FEET TO A POINT ON THE WEST LINE OF LION COUNTRY SAFARI ROAD (AN 80 FOOT ROAD EASEMENT AS DESCRIBED AND RECORDED IN OFFICIAL RECORD BOOK 2062, PAGE 1763, PUBLIC RECORDS, PALM BEACH COUNTY, FLORIDA); THENCE, SOUTH 00°56'48" WEST, ALONG SAID WEST LINE, A DISTANCE OF 100.00 FEET TO A POINT IN THE SOUTH LINE OF SAID SECTION 23, SAID POINT ALSO BEING THE NORTH LINE OF THE PLAT OF FOX TRAIL, ACCORDING TO THE PLAT THEREOF, AS RECORDED IN PLAT BOOK 31, PAGES 157 THROUGH 162, INCLUSIVE, PUBLIC RECORDS, PALM BEACH COUNTY, FLORIDA; THENCE, NORTH 89°04'05" WEST, ALONG SAID LINE, A DISTANCE OF 2413.59 FEET TO THE NORTHWEST CORNER OF SAID PLAT OF FOX TRAIL; THENCE, SOUTH 00°58'44" WEST, ALONG THE WESTERLY LINE OF SAID PLAT, A DISTANCE OF 219.99 FEET; THENCE, NORTH 44°04'39" WEST, A DISTANCE OF 311.16 FEET TO THE SOUTHEAST CORNER OF SAID SECTION 22; THENCE, CONTINUE NORTH 44°04'39" WEST, A DISTANCE OF 509.12 FEET TO THE NORTH LINE OF THE SOUTH 360.00 FEET OF SAID SECTION 22; THENCE, NORTH 89°04'39" WEST, ALONG SAID LINE, A DISTANCE OF 4878.01 FEET TO THE EAST LINE OF SAID SECTION 21; THENCE, NORTH 00°19'18" WEST, ALONG SAID LINE, A DISTANCE OF 0.15 FEET TO THE NORTH LINE OF THE SOUTH 360.00 FEET OF SAID SECTION 21; THENCE, NORTH 88°14'07" WEST, ALONG SAID LINE, A DISTANCE OF 5241.23 FEET TO THE WEST LINE OF SAID SECTION 21; THENCE, NORTH 01°14'39" EAST, ALONG SAID LINE, A DISTANCE OF 5187.93 FEET TO THE NORTHWEST CORNER OF SAID SECTION 21; THENCE, SOUTH 89°22'25" EAST, ALONG THE NORTH LINE OF SAID SECTION 21, A DISTANCE OF 5096.71 FEET TO THE NORTHWEST CORNER OF SAID SECTION 22; THENCE, SOUTH 87°15'07" EAST, ALONG THE NORTH LINE OF SAID SECTION 22, A DISTANCE OF 5284.92 FEET TO THE POINT OF BEGINNING.

CONTAINING: 1260.494 ACRES, MORE OR LESS.

HAVE CAUSED THE SAME TO BE SURVEYED AND PLATTED AS SHOWN HEREON AND DO HEREBY DEDICATE AS FOLLOWS:

- 1. ALL INGRESS AND EGRESS EASEMENTS SHOWN HEREON ARE GRANTED TO THE OWNERS OF THE LOTS SHOWN HEREON, THEIR HEIRS, SUCCESSORS, AND ASSIGNS, AS AN APPURTENANCE HOWEVER TO SAID LOTS FOR ACCESS, INGRESS AND EGRESS, UTILITIES AND DRAINAGE PURPOSES, AND SAID EASEMENTS ARE THE PERPETUAL MAINTENANCE OBLIGATION OF THE DEER RUN PROPERTY OWNERS' ASSOCIATION, INC., A NON-PROFIT CORPORATION.
2. RECREATION, UTILITY AND DRAINAGE EASEMENTS, (R.U. & D. EASE.), AS SHOWN HEREON ARE GRANTED TO THE OWNERS OF THE LOTS SHOWN HEREON, THEIR HEIRS, SUCCESSORS, AND ASSIGNS, AS AN APPURTENANCE TO SAID LOTS FOR PROPER PURPOSES AND ARE THE PERPETUAL MAINTENANCE OBLIGATION OF THE DEER RUN PROPERTY OWNERS' ASSOCIATION, INC., A NON-PROFIT CORPORATION.
3. A 40 FOOT RECREATION, UTILITY AND DRAINAGE EASEMENT, (R.U. & D. EASE.), CENTERED ON ALL LOT LINES AND PORTIONS THEREOF, WHERE EASEMENTS ARE NOT SHOWN ON THIS PLAT, IS HEREBY GRANTED TO THE OWNERS OF THE LOTS HEREON, THEIR HEIRS, SUCCESSORS, AND ASSIGNS, AS AN APPURTENANCE TO SAID LOTS TO BE USED FOR RECREATION, UTILITY AND DRAINAGE PURPOSES.

IN WITNESS WHEREOF SAFARI RANCHETTE ESTATES, INC., A FLORIDA CORPORATION, HAS CAUSED THESE PRESENTS TO BE SIGNED BY ITS PRESIDENT AND ATTESTED TO BY ITS SECRETARY, AND ITS CORPORATE SEAL TO BE AFFIXED HEREON, BY AND WITH THE AUTHORITY OF ITS BOARD OF DIRECTORS, THIS 21st DAY OF JUNE, A.D., 1978.

ATTEST: CLARENCE RAUTENSTRAUCH, SECRETARY; THOMAS S. WALDRON, PRESIDENT

IN WITNESS WHEREOF, I, THOMAS S. WALDRON, ATTORNEY IN FACT, DO HEREUNTO SET MY HAND AND SEAL THIS 21st DAY OF JUNE, A.D., 1978.

Witness: THOMAS S. WALDRON, ATTORNEY IN FACT

ACKNOWLEDGMENT: BEFORE ME PERSONALLY APPEARED THOMAS S. WALDRON AND CLARENCE RAUTENSTRAUCH, TO ME WELL KNOWN AND KNOWN TO ME TO BE THE INDIVIDUALS DESCRIBED IN AND WHO EXECUTED THE FOREGOING INSTRUMENT AS THOMAS S. WALDRON, PRESIDENT AND CLARENCE RAUTENSTRAUCH, SECRETARY OF THE ABOVE NAMED SAFARI RANCHETTE ESTATES, INC., A FLORIDA CORPORATION, AND SEVERALLY ACKNOWLEDGED TO AND BEFORE ME THAT THEY EXECUTED SUCH INSTRUMENT AS PRESIDENT AND SECRETARY, RESPECTIVELY OF SAID CORPORATION, AND THAT THE SEAL AFFIXED TO THE FOREGOING INSTRUMENT IS THE CORPORATE SEAL OF SAID CORPORATION AND THAT IT WAS AFFIXED TO SAID INSTRUMENT BY DUE AND REGULAR CORPORATE AUTHORITY AND THAT SAID INSTRUMENT IS THE FREE ACT AND DEED OF SAID CORPORATION.

WITNESS MY HAND AND OFFICIAL SEAL THIS 21st DAY OF JUNE, A.D., 1978.

NOTARY PUBLIC: MY COMMISSION EXPIRES: 7-6-80

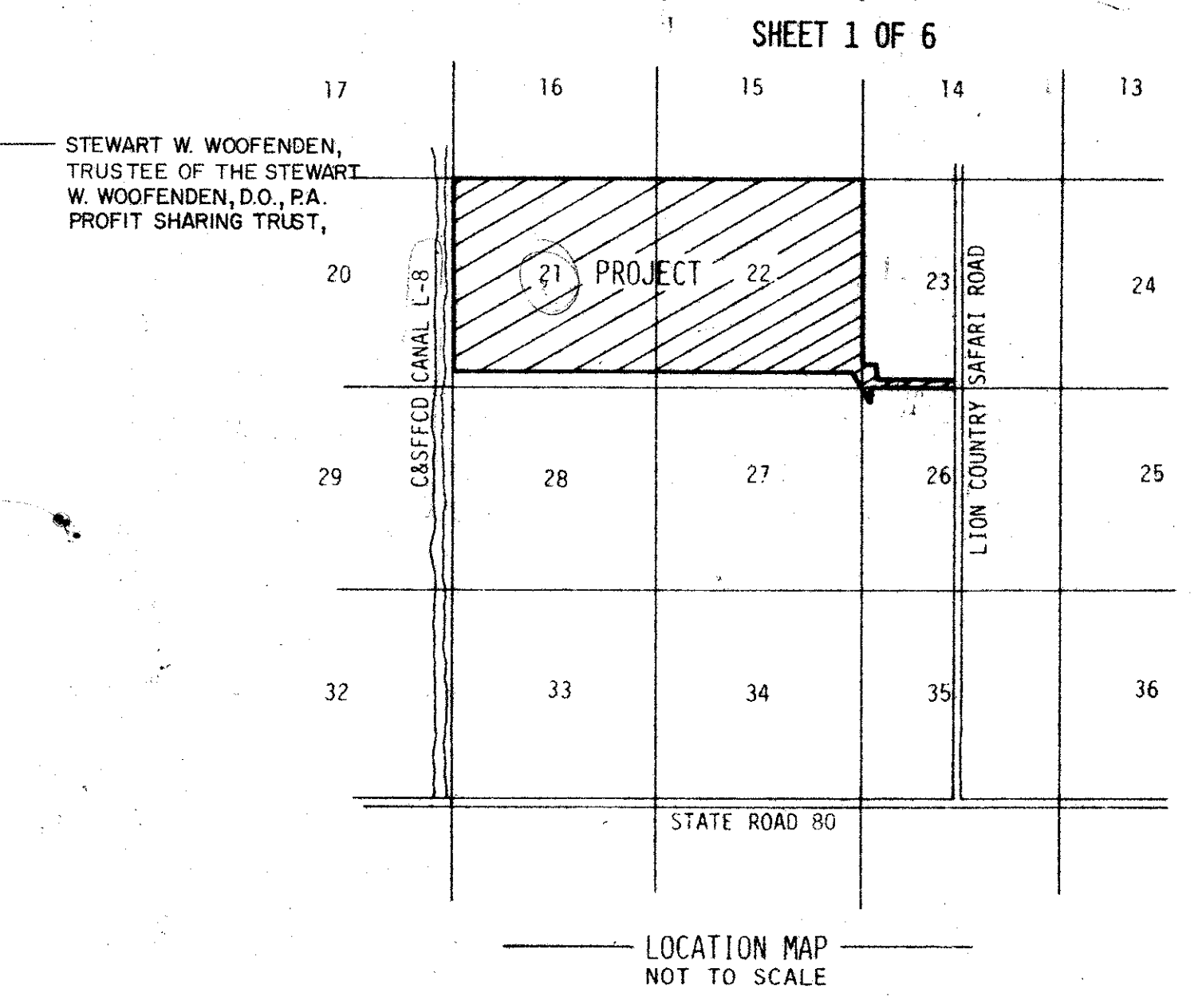

MORTGAGEES CONSENT: STATE OF TENNESSEE COUNTY OF SHELBY

THE UNDERSIGNED HEREBY CERTIFIES THAT IT IS THE HOLDER OF MORTGAGES OR OTHER ENCUMBRANCES UPON THE PROPERTY DESCRIBED HEREON AND DOES HEREBY JOIN IN AND CONSENT TO THE DEDICATION OF THE LAND DESCRIBED IN SAID DEDICATION BY THE OWNERS THEREOF, AND AGREES THAT THE FOLLOWING MORTGAGES OR OTHER ENCUMBRANCES SHALL BE SUBORDINATED TO THE DEDICATION SHOWN HEREON.

- (1) SAFARI RANCHETTE ESTATES, INC., A FLORIDA CORPORATION, TO UNION PLANTERS NATIONAL BANK OF MEMPHIS, AS RECORDED IN O.R. BOOK 2829, PAGE 1730, PUBLIC RECORDS, PALM BEACH COUNTY, FLORIDA.
(2) MAJOR REALTY CORPORATION, A DELAWARE CORPORATION, TO INDIAN TRAIL RANCH, A FLORIDA CORPORATION, AS RECORDED IN O.R. BOOK 2302, PAGE 1264, PUBLIC RECORDS, PALM BEACH COUNTY, FLORIDA, AND ASSIGNED TO SAMUEL FREDLUND AND ERIC JAVITZ, AS TRUSTEES, AS RECORDED IN O.R. BOOK 2321, PAGE 537, PUBLIC RECORDS, PALM BEACH COUNTY, FLORIDA, AND ASSIGNED TO UNION PLANTERS NATIONAL BANK OF MEMPHIS, AS RECORDED IN O.R. BOOK 2763, PAGE 1509, PUBLIC RECORDS, PALM BEACH COUNTY, FLORIDA.
(3) SAFARI RANCHETTE ESTATES, INC., A FLORIDA CORPORATION, TO MAJOR REALTY CORPORATION, A DELAWARE CORPORATION, AS RECORDED IN O.R. BOOK 2340, PAGE 791, PUBLIC RECORDS, PALM BEACH COUNTY, FLORIDA, AND ASSIGNED TO UNION PLANTERS NATIONAL BANK OF MEMPHIS, AS RECORDED IN O.R. BOOK 2742, PAGE 1442, PUBLIC RECORDS, PALM BEACH COUNTY, FLORIDA.
(4) SAFARI RANCHETTE ESTATES, INC., A FLORIDA CORPORATION, TO UNION PLANTERS NATIONAL BANK OF MEMPHIS, AS RECORDED IN O.R. BOOK 2829, PAGE 1742, PUBLIC RECORDS, PALM BEACH COUNTY, FLORIDA.

IN WITNESS WHEREOF, THE SAID BANK HAS CAUSED THESE PRESENTS TO BE SIGNED BY ITS PRESIDENT AND ATTESTED TO BY ITS VICE-PRESIDENT AND ITS BANK SEAL TO BE AFFIXED HEREON BY AND WITH THE AUTHORITY OF ITS BOARD OF DIRECTORS, THIS 28th DAY OF JUNE, A.D., 1978.

ATTEST: RICHARD A. SHIPP, VICE-PRESIDENT

ACKNOWLEDGMENT: BEFORE ME PERSONALLY APPEARED RICHARD A. SHIPP and CHARLES O. PARKER, TO ME WELL KNOWN AND KNOWN TO ME TO BE THE INDIVIDUALS DESCRIBED IN AND WHO EXECUTED THE FOREGOING INSTRUMENT AS VICE-PRESIDENT AND PRESIDENT OF UNION PLANTERS NATIONAL BANK OF MEMPHIS, A TENNESSEE BANK, AND SEVERALLY ACKNOWLEDGED TO AND BEFORE ME THAT THEY EXECUTED SUCH INSTRUMENT AS SUCH OFFICERS OF SAID BANK, AND THAT THE SEAL AFFIXED TO THE FOREGOING INSTRUMENT IS THE BANK SEAL OF SAID BANK AND THAT IT WAS AFFIXED TO SAID INSTRUMENT BY DUE AND REGULAR BANK AUTHORITY AND THAT SAID INSTRUMENT IS THE FREE ACT AND DEED OF SAID BANK.

WITNESS MY HAND AND OFFICIAL SEAL THIS 28th DAY OF JUNE, A.D., 1978.

NOTARY PUBLIC: LISA M. CROVES, MY COMMISSION EXPIRES: 10-13-80

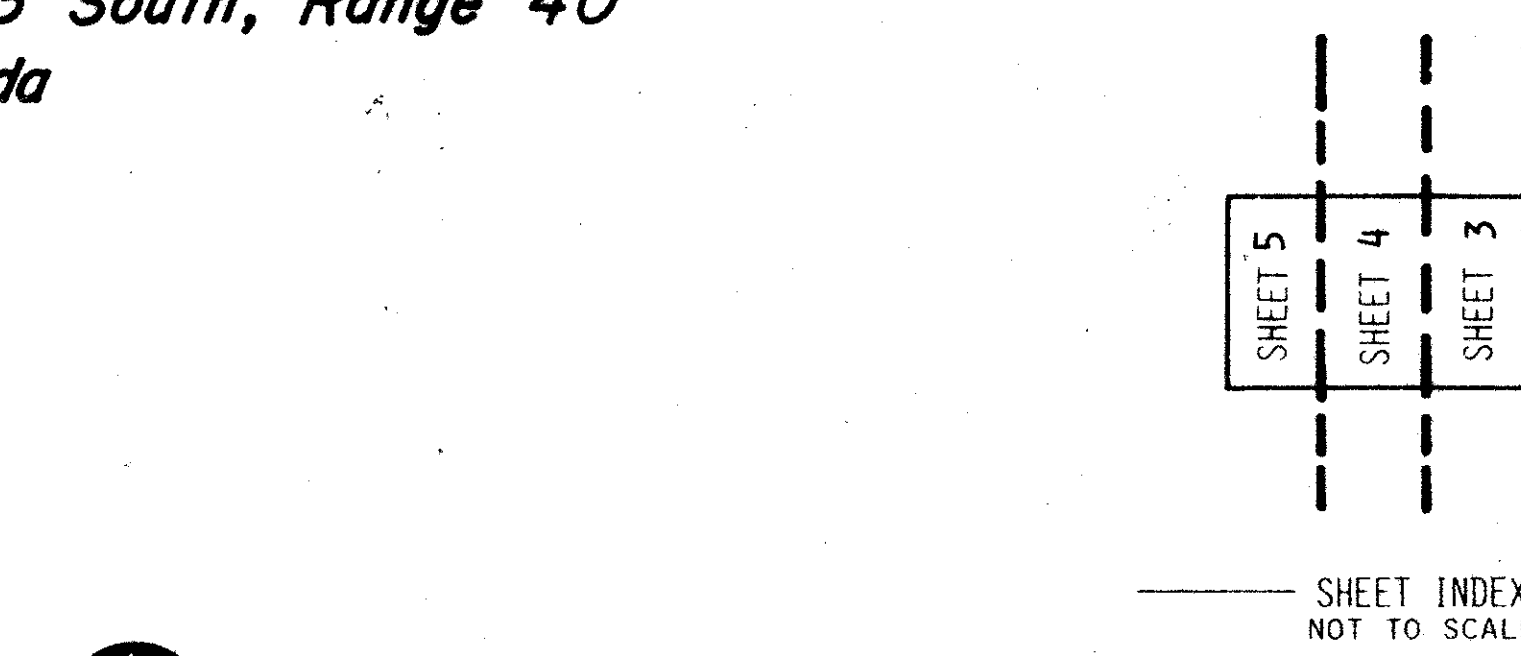

MORTGAGEES CONSENT: STATE OF FLORIDA COUNTY OF PALM BEACH

THE UNDERSIGNED HEREBY CERTIFIES THAT IT IS THE HOLDER OF MORTGAGES OR OTHER ENCUMBRANCES UPON THE PROPERTY DESCRIBED HEREON, AND DOES HEREBY JOIN IN AND CONSENT TO THE DEDICATION OF THE LAND DESCRIBED IN SAID DEDICATION BY THE OWNERS THEREOF, AND AGREES THAT ITS MORTGAGES OR OTHER ENCUMBRANCES WHICH ARE RECORDED IN OFFICIAL RECORD BOOK 2751, PAGES 1228, 1234, 1240, 1246, 1252, 1258, 1264, 1270, 1276, 1282, 1288, 1294, 1300, 1306, 1312, 1318, AND 1324, OF THE PUBLIC RECORDS OF PALM BEACH COUNTY, FLORIDA, SHALL BE SUBORDINATED TO THE DEDICATION SHOWN HEREON.

IN WITNESS WHEREOF, SAID BANK HAS CAUSED THESE PRESENTS TO BE SIGNED BY ITS PRESIDENT AND ATTESTED TO BY ITS VICE-PRESIDENT, AND ITS BANK SEAL TO BE AFFIXED HEREON BY AND WITH THE AUTHORITY OF ITS BOARD OF DIRECTORS, THIS 21st DAY OF JUNE, A.D., 1978.

ATTEST: Margaret E. Carpenter, VICE-PRESIDENT; Eugene G. Kidder, PRESIDENT

ACKNOWLEDGMENT: STATE OF FLORIDA COUNTY OF PALM BEACH

BEFORE ME PERSONALLY APPEARED Margaret E. Carpenter and Eugene G. Kidder, TO ME WELL KNOWN AND KNOWN TO ME TO BE THE INDIVIDUALS DESCRIBED IN AND WHO EXECUTED THE FOREGOING INSTRUMENT AS VICE-PRESIDENT AND PRESIDENT OF THE CENTRAL BANK OF PALM BEACH COUNTY, A FLORIDA BANK, AND SEVERALLY ACKNOWLEDGED TO AND BEFORE ME THAT THEY EXECUTED SUCH INSTRUMENT AS SUCH OFFICERS OF SAID BANK, AND THAT THE SEAL AFFIXED TO THE FOREGOING INSTRUMENT IS THE BANK SEAL OF SAID BANK AND THAT IT WAS AFFIXED TO SAID INSTRUMENT BY DUE AND REGULAR BANK AUTHORITY AND THAT SAID INSTRUMENT IS THE FREE ACT AND DEED OF SAID BANK.

WITNESS MY HAND AND OFFICIAL SEAL THIS 21st DAY OF JUNE, A.D., 1978.

NOTARY PUBLIC: Paul Stevenson, MY COMMISSION EXPIRES: 8-1-80

MORTGAGEES CONSENT: STATE OF FLORIDA COUNTY OF PALM BEACH

THE UNDERSIGNED HEREBY CERTIFIES THAT IT IS THE HOLDER OF MORTGAGES OR OTHER ENCUMBRANCES UPON THE PROPERTY DESCRIBED HEREON AND DOES HEREBY JOIN IN AND CONSENT TO THE DEDICATION OF THE LAND DESCRIBED IN SAID DEDICATION, BY THE OWNERS THEREOF, AND AGREES THAT ITS MORTGAGES OR OTHER ENCUMBRANCES WHICH ARE RECORDED IN OFFICIAL RECORD BOOK 2753, PAGES 1869 AND 1876, PUBLIC RECORDS, PALM BEACH COUNTY, FLORIDA, SHALL BE SUBORDINATED TO THE DEDICATION SHOWN HEREON.

IN WITNESS WHEREOF, SAID BANK HAS CAUSED THESE PRESENTS TO BE SIGNED BY ITS PRESIDENT AND ATTESTED TO BY ITS VICE-PRESIDENT, AND ITS BANK SEAL TO BE AFFIXED HEREON BY AND WITH THE AUTHORITY OF ITS BOARD OF DIRECTORS, THIS 21st DAY OF JUNE, A.D., 1978.

ATTEST: James R. McLann, VICE-PRESIDENT; R.B. Snyder, PRESIDENT

ACKNOWLEDGMENT: STATE OF FLORIDA COUNTY OF PALM BEACH

BEFORE ME PERSONALLY APPEARED James R. McLann and R.B. Snyder, TO ME WELL KNOWN AND KNOWN TO ME TO BE THE INDIVIDUALS DESCRIBED IN AND WHO EXECUTED THE FOREGOING INSTRUMENT AS VICE-PRESIDENT AND PRESIDENT OF FLAGSHIP BANK OF WEST PALM BEACH, A FLORIDA BANK, AND SEVERALLY ACKNOWLEDGED TO AND BEFORE ME THAT THEY EXECUTED SUCH INSTRUMENT AS SUCH OFFICERS OF SAID BANK, AND THAT THE SEAL AFFIXED TO THE FOREGOING INSTRUMENT IS THE BANK SEAL OF SAID BANK AND THAT IT WAS AFFIXED TO SAID INSTRUMENT BY DUE AND REGULAR BANK AUTHORITY AND THAT SAID INSTRUMENT IS THE FREE ACT AND DEED OF SAID BANK.

WITNESS MY HAND AND OFFICIAL SEAL THIS 21st DAY OF JUNE, A.D., 1978.

NOTARY PUBLIC: Carol Butzberger, MY COMMISSION EXPIRES: 1-1-81

SURVEYOR'S CERTIFICATE: STATE OF FLORIDA COUNTY OF PALM BEACH. THIS IS TO CERTIFY THAT THE PLAT SHOWN HEREON IS A TRUE AND CORRECT REPRESENTATION OF A SURVEY MADE UNDER MY RESPONSIBLE DIRECTION AND SUPERVISION AND THAT SAID SURVEY IS ACCURATE TO THE BEST OF MY KNOWLEDGE AND BELIEF AND THAT (P.R.M.'S) PERMANENT REFERENCE MONUMENTS HAVE BEEN PLACED AS REQUIRED BY LAW, AND FURTHER THAT THE SURVEY DATA COMPLIES WITH ALL THE REQUIREMENTS OF CHAPTER 177, FLORIDA STATUTES, AS AMENDED, AND ORDINANCES OF PALM BEACH COUNTY, FLORIDA. DATE: 10 DAY OF July, A.D., 1978. BY: [Signature] SURVEYOR NO. 2424 STATE OF FLORIDA

- 1. THERE SHALL BE NO BUILDING OR ANY KIND OF CONSTRUCTION OR TREES OR SHRUBS PLACED ON DRAINAGE EASEMENTS.
2. THERE SHALL BE NO BUILDINGS OR ANY OTHER KIND OF PERMANENT STRUCTURES PLACED ON UTILITY EASEMENTS.
3. BUILDING SETBACK LINES SHALL BE AS REQUIRED BY CURRENT PALM BEACH COUNTY ZONING REGULATIONS.
4. ALL BEARINGS STATED HEREON AND AS SHOWN HEREON ARE BASED ON AN ASSUMED BEARING OF NORTH 89°04'39" WEST FOR THE SOUTH LINE OF SECTION 22-43-40.

APPROVAL: PALM BEACH COUNTY, FLORIDA BOARD OF COUNTY COMMISSIONERS. THIS PLAT IS HEREBY APPROVED FOR RECORD THIS 12 DAY OF July, A.D., 1978.

BY: [Signature] COUNTY ENGINEER

THIS PLAT IS HEREBY APPROVED FOR RECORD THIS 18 DAY OF July, A.D., 1978.

BY: [Signature] COUNTY ENGINEER

ATTEST: JOHN B. DUNKLE, CLERK BOARD OF COUNTY COMMISSIONERS; 1800-104

TITLE CERTIFICATION: STATE OF FLORIDA COUNTY OF PALM BEACH

WE, STEWART TITLE OF PALM BEACH COUNTY, A DULY LICENSED TITLE INSURANCE COMPANY IN THE STATE OF FLORIDA, DO HEREBY CERTIFY THAT WE HAVE EXAMINED THE TITLE TO THE HEREIN DESCRIBED PROPERTY; THAT WE FIND THAT THE TITLE TO THE PROPERTY IS VESTED TO SAFARI RANCHETTE ESTATES, INC., A FLORIDA CORPORATION, CHARLES A. NUGENT, JR. AND BARBARA A. NUGENT, HIS WIFE, JOHN B. MCCracken AND CAROL A. MCCracken, HIS WIFE, KEVIN A. REGAN, A SINGLE MAN, DOUGLAS G. HOWELL AND ANN A. HOWELL, HIS WIFE, CLYDE D. COCHRAN AND ANN S. COCHRAN, HIS WIFE, RAY A. MAIURUM, D.D.S., AND JUDITH E. MAIURUM, HIS WIFE, ALAN J. CIKLIN, A SINGLE MAN, H. NORMAN BOTT AND MARY E. BOTT, HIS WIFE, DAVID ROTH AND NANCY ROTH, HIS WIFE, LAKE LYTAL, JR. and SUSAN LYTAL, HIS WIFE, JOSEPH J. REITER, AND JANICE REITER, HIS WIFE, DR. HARRY E. LANGE, LAWRENCE KLEIN AND LYNN KLEIN, HIS WIFE, CHARLES R. REIF and IVA M. REIF, HIS WIFE, PHILIP G. BUTLER, JR., A SINGLE MAN, DONALD J. SMITH AND JANE SMITH, HIS WIFE, DONALD A. HUGHES, JR., and MARY LOU HUGHES, HIS WIFE, RICHARD G. LUBIN and LOIS J. FRANKEL, HIS WIFE, PETER A. MANZ and SARAH H. MANZ, HIS WIFE, JERRY G. GUFFEY, D.D.S., P.A. PROFIT SHARING TRUST, IAN MURPHY and ROSE MARIE MURPHY, HIS WIFE, STEWART W. WOOFENDEN, TRUSTEE OF THE STEWART W. WOOFENDEN, D.O., P.A. PENSION TRUST, GENE A. TONN, SAMUEL YELIN, CARLOS RODRIGUEZ, MAXIMO GOMEZ, MILTON LAVERNIA, ANTONIO LOPEZ, JOSEPH W. WALIGA and LILLIAN C. WALIGA, HIS WIFE, AND ALBERT ASSADOURIAN; THAT THE CURRENT TAXES HAVE BEEN PAID; AND THAT WE FIND THE PROPERTY IS NOT ENCUMBERED BY ANY MORTGAGES OTHER THAN THOSE SHOWN HEREON. STEWART W. WOOFENDEN, TRUSTEE OF THE STEWART W. WOOFENDEN, D.O., P.A. PROFIT SHARING TRUST;

DATE: 13th DAY OF June, A.D., 1978. BY: [Signature] LINDA W. COVNER, C.L.S., VICE-PRESIDENT

CONRAD W. SCHAEFER CONSULTING ENGINEERS, INC. PALM BEACH COUNTY, FLORIDA. DEER RUN. A grid with columns for 'DATE', 'BY', 'JOB NO.', 'SHEET NO.', 'SCALE'. Values include '7-7-11', 'R.J.W.', '77-111', '35/34', '1-6'.

A series of circular notary seals for various entities: SAFARI RANCHETTE ESTATES, MAJOR REALTY CORPORATION, UNION PLANTERS NATIONAL BANK OF MEMPHIS, FLAGSHIP BANK, CENTRAL BANK OF PALM BEACH COUNTY, CENTRAL BANK, CO. CLERK, CO. ENG'R., SURVEYOR. Large text 'DEER RUN' and '35/34' is overlaid on the bottom of the page.